

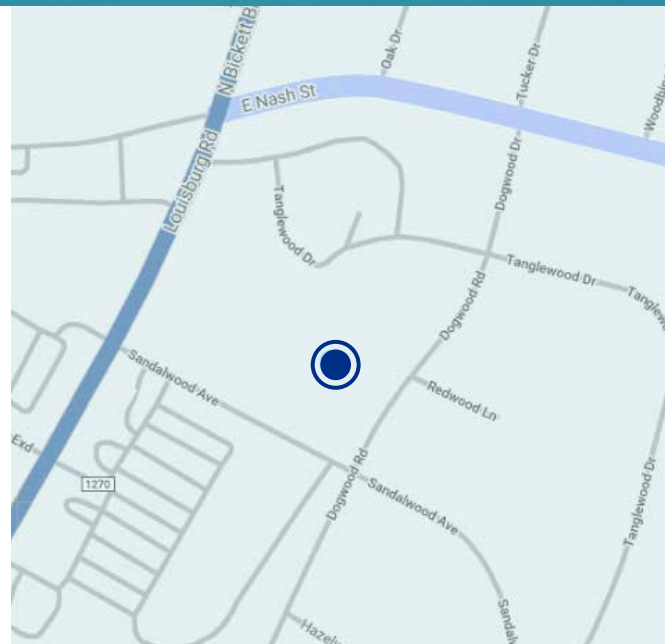

OVERVIEW

- One-level, 13,549 SF brick building
- Situated on 1.6 acres
- Zoned for office or retail, up-fitted for medical use
- Located just off US-401 in Louisburg
- Neighborhood substantially developed with retail, office, and hotels
- Few medical facilities available in Franklin County





SPACE DETAILS

- Unit A
 - 8,000 SF
 - 16 exam rooms
 - \$17.00/SF, NNN
- Unit B
 - 2,860 SF
 - Nine exam rooms
 - \$17.00/SF, NNN
- Each space has reception area, waiting rooms, and break room
- Five-year term preferred for each space

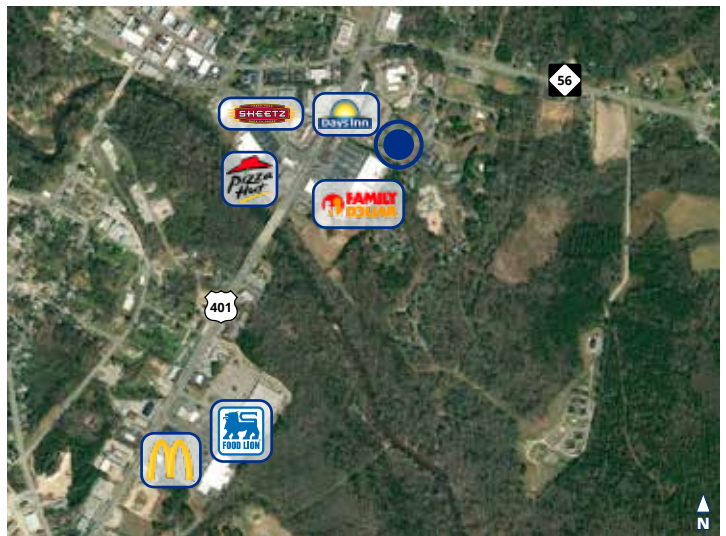

FRED DICKENS

fdickens@trademarkproperties.com
919.227.5508 direct 919.673.4775 mobile

The information contained herein was obtained from sources believed reliable; however, TradeMark Properties makes no guarantees, warranties, or representations as to the completeness or accuracy thereof. The presentation of this property is submitted subject to errors, omissions, changes of price or conditions prior to sale or lease, or withdrawal without notice.

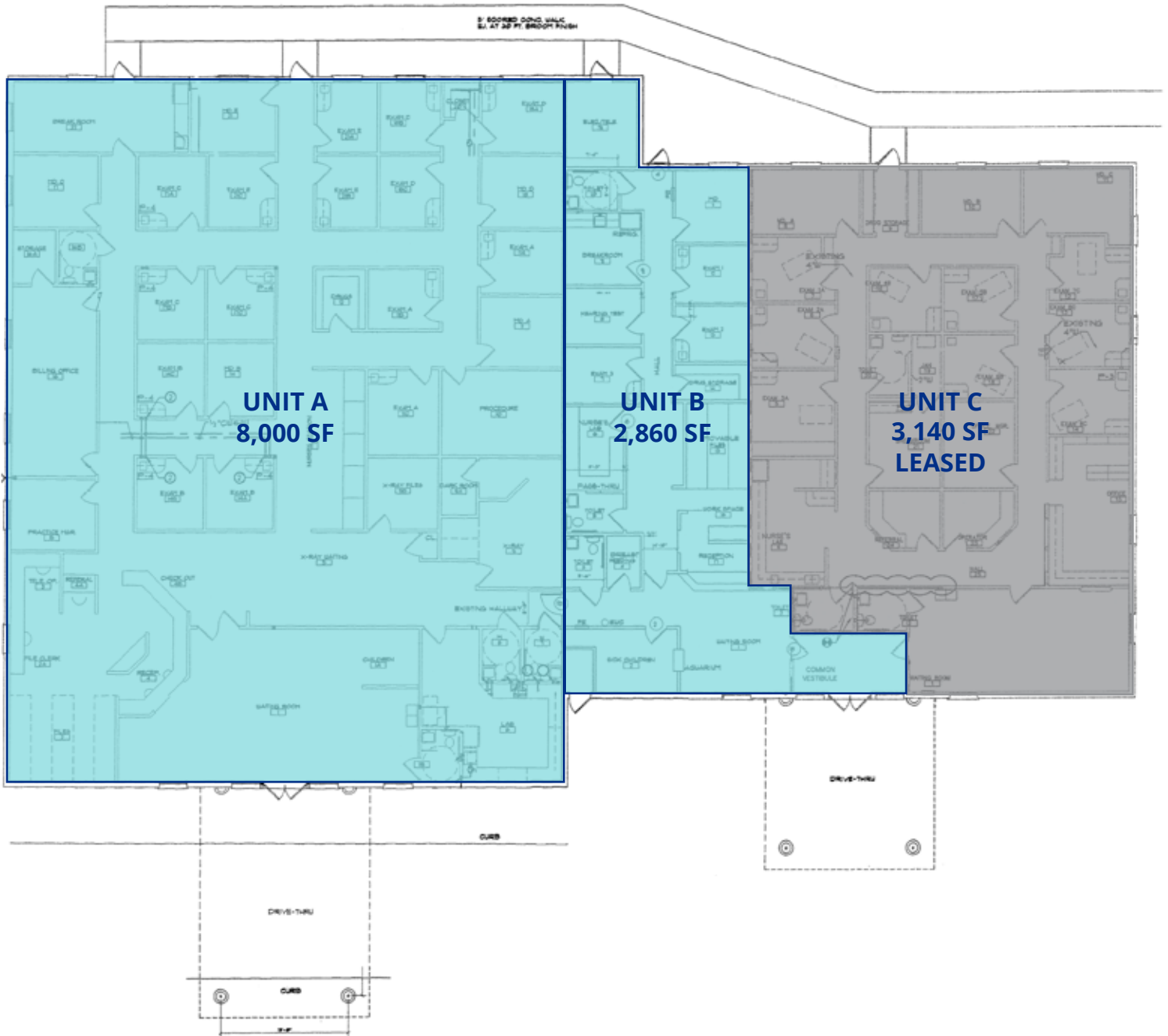

FRED DICKENS

fdickens@trademarkproperties.com
919.227.5508 direct 919.673.4775 mobile